

Component Test

Air permeability and watertightness of a joint filling system for connecting joints between window and wall in new condition (immediately after installation) and after simulated short-term exposure to repeated cycles.



Test Report 105 34243/1e

Client **ROBITEX GROUP**
Mojayskoe shosse 25

RUS-121471 Moscow

Basis
ift-Guideline MO-01/1 : 2007-01
Wall connection of windows,
Part 1: Method to determine the
suitability of use of sealing sys-
tems, section 5, Test of joint
characteristics

Product / component	Sealing system between window and wall
Designation	Sealing: internal on sides and at top: ① ROBIBAND VS (Variant 1) ROBIBAND VM (Variant 2) in spandrel area: ② ROBIBAND PB external continuous: ③ ROBIBAND NL Tape overlaps joints and the adhesive joint with the building fabric additionally sealed with acrylate-based sealer
Mounting position and general installation conditions	Rendered lime sand brickwork with flush reveal. Plastic window with steel reinforcement in the casement and window frame. Fixing to structure: perimeter-fixed to wall with frame screws (without dowel), fastener spacing ≤ 700 mm. Joint on the room side sealed between window frame and unplastered wall reveal; on the outside between the window frame and rendered brickwork. Installation/processing in accordance with client's instructions.
Field of application	Joint sealing system between external wall and window and/or equivalent casement doors in white hollow PVC profile construction, as described above, for internal air tightness and external watertightness.
Special features	For the purpose of testing, the test rig did not include a thermal insulating system, an aluminium window sill, plaster finish on the inside reveal or any joint insulation.

Representation

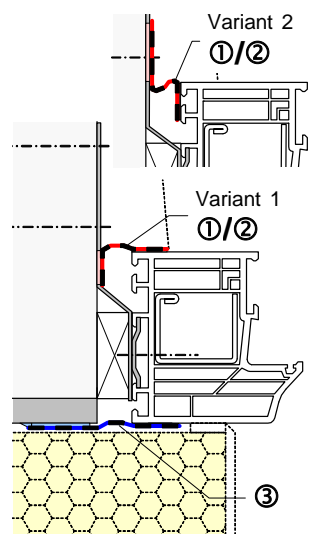

Instructions for use

This test report serves to demonstrate the above-mentioned characteristics.

Validity

The data and results given relate solely to the tested and described test specimen.

Notes on publication

The ift Guidance Sheet "Conditions and Guidance for the Use of ift Test Documents" applies.

The cover sheet can be used as abstract.

Results *)



Air permeability at up to ± 1,000 Pa, in new condition	$a < 0.1 \text{ m}^3/(\text{m h daPa}^{2/3})$
Simulated short-term exposures (changes in temperature, wind, operation)	Visually no adverse effect on the connecting joints
Air permeability at up to ± 1,000 Pa, after simulated short-term exposures	$a < 0.1 \text{ m}^3/(\text{m h daPa}^{2/3})$
Watertightness at up to 600 Pa, after simulated short-term exposures	no water penetration

*) For detailed results see test report, Section 3

ift Rosenheim
16. March 2009

Jörn Peter Lass, Dipl.-Ing. (FH)
Head of Testing Department
ift Centre Windows & Facades

Wolfgang Jehl, Dipl.-Ing. (FH)
Test Engineer
ift Centre Windows & Facades

Contents

The test report comprises a total of 23 pages

- 1 Object
- 2 Procedure
- 3 Detailed results
- 4 Annex



ift Rosenheim GmbH
Geschäftsführer:
Dipl.-Ing. (FH) Ulrich Sieberath
Dr. Jochen Peichl

Theodor-Giell-Str. 7 - 9
D-83026 Rosenheim
Tel.: +49 (0)8031/261-0
Fax: +49 (0)8031/261-290
www.ift-rosenheim.de

Sitz: 83026 Rosenheim
AG Traunstein, HRB 14763
Sparkasse Rosenheim
Kto. 3822
BLZ 711 500 00

Notified Body Nr.: 0757
Anerkannte PUZ-Stelle: BAY 18

DAP-PL-0908 99
DAP-ZE-2288 00
TGA-ZM-16-93-00
TGA-ZM-16-93-60